



240094000

240094000
Sept
01

**POSTED AT THE
CONSTRUCTION SITE**

Becker County Planning & Zoning
835 Lake Ave, P O Box 787
Detroit Lakes, MN 56502-0787
Phone (218)-846-7314; Fax (218)-846-7266

Onsite Septic System Site Evaluation/Design Tax Parcel Number 24.0094.000 911 Address 26142 Cty Hwy 21

Legal Description: 10 rds N & S by 16 rds E & W lying Section 12 TWP 140 Range 91
70 rds N & 5 rds W of SE cor of SE 1/4 SW 1/4

Lake Name _____ Lake Classification _____ Township Name Rich wood

Owner's Name Bill + Helen Chelma Address 26142 County Hwy 21

City Detroit Lakes State/Zip Mn 56501 Phone Number 218 847-4692

Number of Bedrooms 3
Design Flow 450 GPD

Well Casing Depth _____
Depth of other Wells within
100 ft of system _____

Garbage Disposal (Yes) (No)
Grinder Pump/Lift Station
In House (Yes) (No)

Type of Observation: Probe Pit Boring
Original Soil (Yes) (No) Compacted Soil (Yes) (No)
Depth to Restricting Layer 72
Maximum of Depth of System 3
Perc Rate _____ Soil Sizing Factor 1.67

Proposed Design
 Replace Septic Tank
 Septic Tank/Drainfield
 Drainfield Only
 Holding Tank
 Lift Station

Type of Drainfield
 Standard (gravelless chamber)
 Standard (rock depth _____)
 Standard Bed
 Mound At Grade
 Pressurized Bed

(2 bdrm house - garage may have bedroom and bathroom later)

SOIL BORING LOG

DEPTH (INCHES)	TEXTURE	COLOR & MUNSELL NO.	STRUCTURE
0-6	loam	10YR2/2	BLOCKY PLATY PRISMATIC NONE
8-30	Sandy loam	10YR4/4	BLOCKY PLATY PRISMATIC NONE
31-58	Sandy loam	10YR5/4	BLOCKY PLATY PRISMATIC NONE
59-72	Sandy	10YR6/4	BLOCKY PLATY PRISMATIC NONE

SOIL BORING LOG

DEPTH (INCHES)	TEXTURE	COLOR & MUNSELL NO.	STRUCTURE
			BLOCKY PLATY PRISMATIC NONE
			BLOCKY PLATY PRISMATIC NONE
			BLOCKY PLATY PRISMATIC NONE
			BLOCKY PLATY PRISMATIC NONE

Type of alarm
Device on lift
Station or
Holding tank

Attach perc test
Information if
Required

Name and Address of Designer Patricia Stock Phone 218 935 5981

MPCA Number 2029 Date of Site Evaluation _____ Signature of Designer _____

Name of Installer (if different from Designer) _____ MPCA Number _____

FOR USE BY BECKER COUNTY ENVIRONMENTAL SERVICES DEPARTMENT ONLY

*** Any changes to the permit must first be approved by Becker County Planning & Zoning. No system shall be covered up without inspection by Becker County Planning & Zoning.

*** Inspections must be scheduled at least 24 hours prior to time requested.

Date Received 7/24/01 Application Fee 75⁰⁰ State Surcharge 0 Total 75⁰⁰

[] Application is hereby denied

[X] Application is hereby granted to William Chelma to install an individual septic system according to the specifications of the site evaluation and design submitted to the Becker County Environmental Services Office. By Order of:

Nancy Jaung
Signature of Becker County Qualified Employee

7/24/01
Date Permit Issued

16372
Permit Number

This permit expires on 7/24/02

The site plan must be drawn to dimension or to scale:

- *Dimensions of Lot
- *Existing & Proposed Buildings
- *Easements & setbacks
- *Scale - One inch = _____ ft
- *Well & Water Line Locations within 100 ft of System
- *Distance from Property Lines
- *Tank Access Route
- *Location of any Unsuitable Soil
- *Distance from OHWM
- *Distance from buildings
- *Soil Borings & Per Test Locations
- *Alternate Drainfield Location

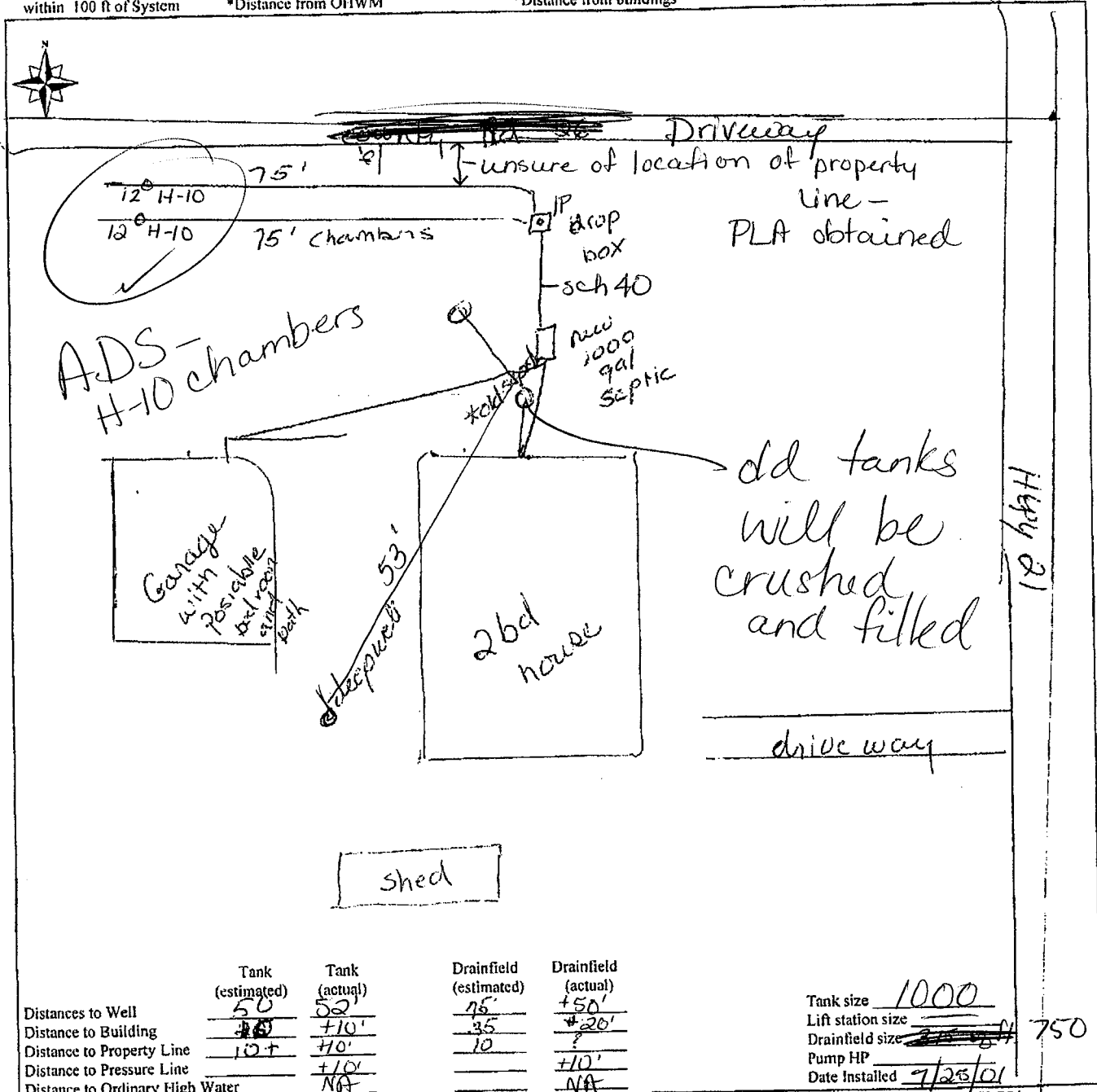

	Tank (estimated)	Tank (actual)	Drainfield (estimated)	Drainfield (actual)	
Distances to Well	50	52	75'	+50'	Tank size 1000
Distance to Building	40	+10'	35	+20'	Lift station size
Distance to Property Line	10'	+10'	10	?	Drainfield size 200 sq ft 750 sq ft
Distance to Pressure Line		+10'		+10'	Pump HP
Distance to Ordinary High Water		NA		NA	Date Installed 7/25/01

FOR USE BY BECKER COUNTY ENVIRONMENTAL SERVICES DEPARTMENT ONLY

CERTIFICATE OF COMPLIANCE

() Certificate Is Hereby Denied
 (✓) Certificate is Hereby Granted Based upon the Application, addendum from, plans, specifications and all other supporting data.
 With property maintenance, this system can be expected to function satisfactory, however, this is not a guarantee.

Nancy Young Signature Title Zoning Inspector Date 7/25/01
 (Certificate of Compliance is not valid unless signed by a Registered Qualified Employee)

Sept
01

PROPERTY LINE AGREEMENT

I Tim Anderson, give Bill Chelmo, permission to have their sewer system closer than the required 10 feet to the lot line.

SIGNED 

DATE 7-25-01